

User's Guide for BTA1000

V1.00

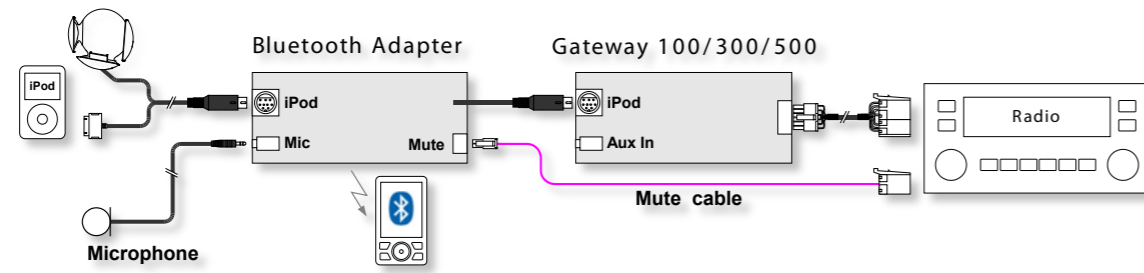

IMPORTANT NOTE!

Improved features of BTA1000 require 2.02 or later Firmware (FW) version on all Gateway. FW version is displayed in the upper right corner of the Warning! splash screen on the iPod when connected to the Gateway. If your Gateway has older FW, please download the FW upgrade package (including instructions and current Manual) from <http://install.dension.com> Upgrade can be done after the installation as well – until that the BTA will work according its old operation method, described in the original Gateway manual.

BTA1000 is an optional Bluetooth Accessory kit for the Gateway 100/300/500 devices. It supports:

- A2DP/AVRCP profiles for audio playback and
- HFP/HSP profiles for handsfree telephony

BTA1000 is compatible with most Bluetooth-equipped mobile phones, PDAs, media players and other devices, however, the Bluetooth standard is not consistently implemented by device manufacturers and you may find that apart from basic compatibility, some functions may not be accessible from your specific device. In case of doubt, please check the Knowledge Base at <http://support.dension.com>.

For best performance, install BTA1000 far away from the car radio chassis or other electronic equipment and avoid installing near large metal objects. It is recommended to mount BTA1000 to a plastic part of the vehicle or to tie it to a cable harness.

If you intend to use BTA1000 for hands free telephony, install the microphone and radio mute cable, too.

Fix the Microphone jack plug with the included piece of plastic.

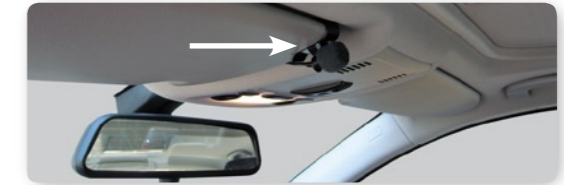

For optimum hands-free performance, place the microphone as close to the driver mouth as possible, but at the same time in a central location, i.e. an equal distance from the left and right front speakers. Ideally clip the microphone to an overhead panel at the top of the windscreen, e.g. near the interior light.

When using BTA1000 for hands-free operation, we recommend setting the radio volume to a level that enables you to hear the other party well, but does not create too much echo for the other party. We recommend first setting your telephone volume using the handset volume controls to achieve a similar volume level to other audio sources connected to the Gateway.

The package includes pre-assembled leads to connect the BTA1000 to the radio telephone mute connector (where available and supported).

Insert the illustrated end of the mute lead into the proper position of the 4 pin microfit housing. Insert the other end to the correct radio location detailed below:

Car type	Mute cable	Pin position on 4p Microfit	Radio side plastic and position
Alfa	white	A2	I9
Audi	blue	A2	E1
Blaupunkt	white	A2	I9
BMW 40pin	green	A2	H10
BMW 17pin	orange	A2	J4
Fiat	white	A2	I9
Ford CAN	yellow	A2	G5
Lexus	grey	A2	B6
Toyota A-old	brown	A2	D4
Toyota B-new	grey	A2	B6
VW CAN	green	A2	F11
VW 8pin	blue	A2	C1

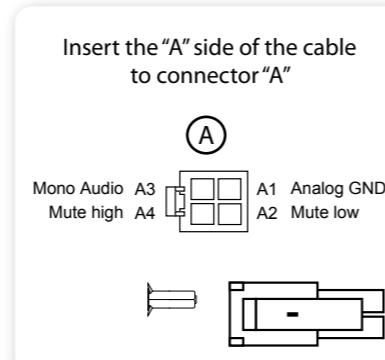

Note:

- Some car radios do not feature a telephone mute. In these cases the radio will not be automatically muted for an incoming calls when a Gateway source is not selected.

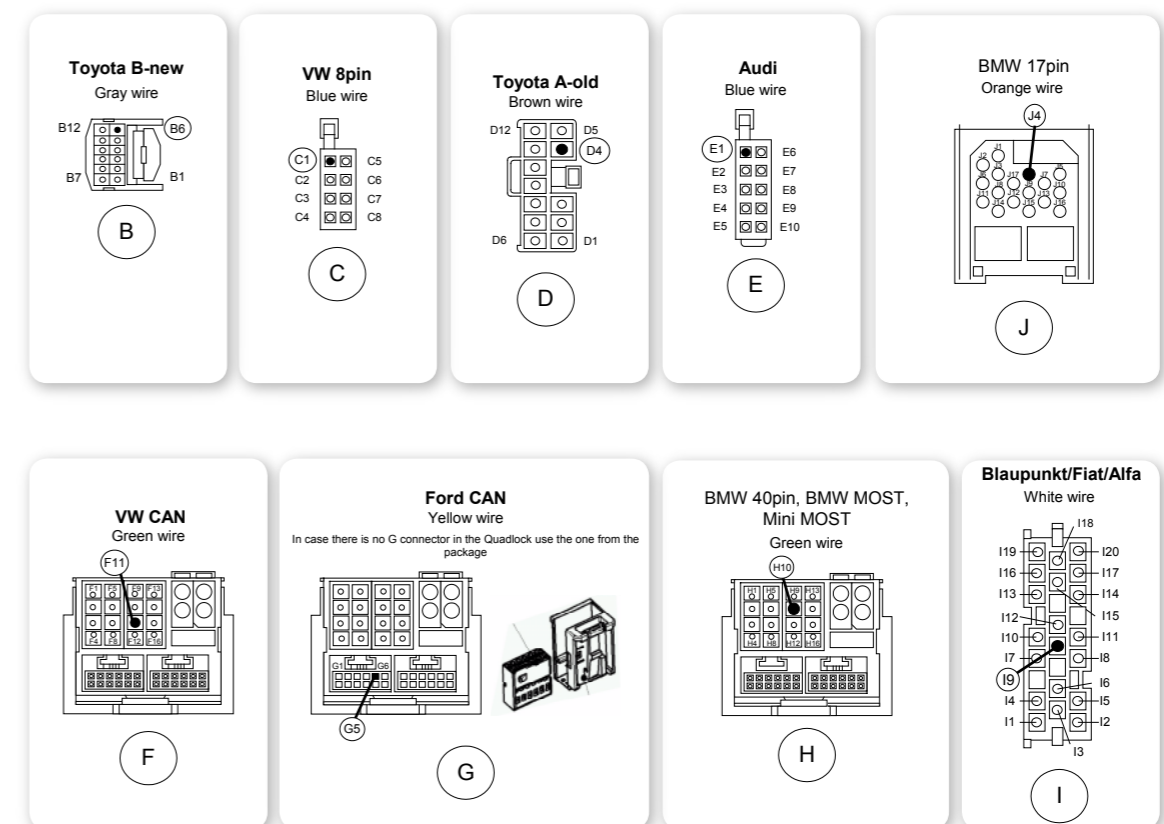

Operation

General operation of the Gateway and source selection is detailed in its User Manual. As a reminder:

- for Bluetooth audio source, select Disc6/Track5 and press FF.
- for Bluetooth hands-free operation, select Disc6/Track6 and press FF.
- or just follow the Menu on text capable applications

	Other devices	Bluetooth Audio	Bluetooth Hands Free	Other devices
Track #	1-4	5	6	7-9
Disc #				
6		Menu/Source Select	Menu/Source Select	
5		Parking Next = Next Track Pairing (if not connected) Back = Back Track	Parking Next = Accept incoming Call Voice Dial Pairing (if not connected) Back = Reject / Terminate Call Redial	
4		-	-	
3		-	-	
2		-	-	
1		Setup	Setup	

5

Setup

BTA1000 stores the last 4 paired devices. At power on, BTA1000 automatically connects to the latest available device in the order of previous connections.

To manage pairing, BTA1000 assigns commands to various Track# of Disc1. To activate a command select Disc1, set the relevant Track# and press FF to confirm the selection:

Track1	Disconnect current device. Use this command if you want to close the connection temporarily or you want to pair a new device.
Track2	Connect: Restart connection process with previously paired devices. Useful if you have disconnected the device or the connection has been lost for any reason.
Track3	Pairing: Set up a new connection with all available profiles. It does not matter in which profile you operate this function, the Gateway will connect all profiles to the same Bluetooth device. Allow pairing on the Bluetooth device and enter Pin# 0000 to establish the connection. Start the pairing process on both devices at the same time to avoid unwanted termination by a minute time out.
Track4	Clear list of paired devices and disconnects the actual device.
Track5	Advanced pairing: Disconnects the current device in the selected profile and starts a new pairing for the selected profile only. This allows you to connect different devices for audio or hands-free use.
Track6	Disable: Disconnects the actual device and permanently disables hands free operation on the BTA1000. Use this command, if you do not want to use the BTA1000 for hands free operation - e.g. you have another hands free kit installed in your vehicle. You can re-enable hands free operation by selecting Connect command (Disc1/Track2). Available in hands free mode only.

Notes:

- For successful connection you need to configure your Bluetooth device too! Please consult the device user guide for information regarding specific functionality.
- Some telephones store paired device information for a long time and do not allow a new connection attempt with a stored PIN. To reconnect a previously used device with BTA1000 after 4 different BTA1000 connections, you may need to delete the telephone BTA1000 pairing information before re-pairing.
- Sony/Ericsson devices generally require pairing to be initiated from the device for a successful connection.
- On some Radios with built in browser capability it is not enough to select the track to activate the command, but you must definitely press FF, as described above.

6

Audio

BTA1000 supports A2DP/AVRCP and HSP profiles for audio playback. Due to limitations of these standards no song information is provided by the Bluetooth device and only Next/Back/Pause/Play functions are available from the car radio or the steering wheel.

Note, that with certain Bluetooth devices:

- Playback remote control may not be available
- The media player may have to be started/stopped manually

Navigation prompts from a Bluetooth device

If your device runs navigation software, then select Bluetooth Audio to hear navigation prompts. During this, you may or may not be able to listen to music from the device's media player, depending upon its software characteristics.

Hands Free Calling

To **initiate a call**, first select Bluetooth Hands Free as source device (Disc6/Track6).

To start **Voice Dialing**, simply press Next Track.

To **Redial** the last number press Back Track. Depending upon the implementation on your telephone, this command will dial the last incoming or outgoing number.

You can **dial directly** on the phone as usual. In this case you do not need to select Bluetooth hands free on the radio; you can keep going to listen other Gateway source. Bluetooth hands free will be automatically selected when the connection is established.

Incoming calls activate the Bluetooth Hands Free source automatically if any other Gateway source is selected. To **Accept or Reject** the call, use **Next or Previous** Track buttons.

After finishing the call, the Gateway will return to the original Gateway source.

7

If Radio or CD is selected, than an incoming call mutes the radio periodically allowing you to hear the telephone ring. By selecting the CD Changer source, Bluetooth Hands Free activates automatically and Next/Back track will accept or reject the call, as above. After finishing the call, you can switch back to the Radio manually.

Mute or Pause on the radio disconnects the Bluetooth connection without terminating the actual phone conversation. You can continue the call by using the handset.

Canceling Mute or Play will restore the Bluetooth connection and the hands free mode.

Note: Certain phones are not able to reconnect Bluetooth connection during a call, only just after.

Warranty

BTA1000 carries one year limited warranty that protects you from defects in material and workmanship of products sold by Dension or its authorized distributors and retailers. We do not warrant any installation work or damages due to negligence, improper installation or operation.

For claims a proof of purchase is required.

If you need assistance in using this product, please contact your local supplier or visit <http://support.dension.com>, where you find comprehensive and up to date Knowledge Base support on FAQs, firmware upgrades, Trouble Shooting, or you can contact Technical Support stuff.

Package includes:

- BTA 1000 device
- Microphone with clip
- Jack fixture
- 4pin micro fit connector
- 12 pin Ford connector and connector housing
- Pre-assembled leads
- User guide

8